

# GRAHAM STUDIOS

Broadcast Furniture

## Modulux Custom Instruction Manual



**This manual is a generic guide.** The assembly of a unbalanced “U” is used as an example. Your particular configuration may vary. Please refer to your personalized shop drawing included in packaging.

Please call the factory if you have any questions at (970) 225-1956.

## **Tools needed :**

1. #2 Phillips screw driver ( Power drill with barrel magnet makes it much easier )
2. 2 each— 7/16” open end wrenches

## **Table of Contents**

1. Base assembly. ....	3
2. End panels .....	3
3. Face frames.....	4
4. Punch block cabinet.....	5
5. Door panels .....	6
6. Legs & HP assembly.....	6
7. Tabletops.....	7

## **Care and Maintenance**

Horizontal and vertical surfaces may be cleaned with mild soap and water.  
Wood surfaces should be treated with Johnson paste wax as needed.

*Note : We will replace any damaged part at cost.*

## 1. Base Assembly

Arrange bases appropriately for your studio design.  
( Leave appropriate space for punch block cabinet. )

**Note :** Corner posts for all configurations are numbered starting in the lower left-hand corner as shown

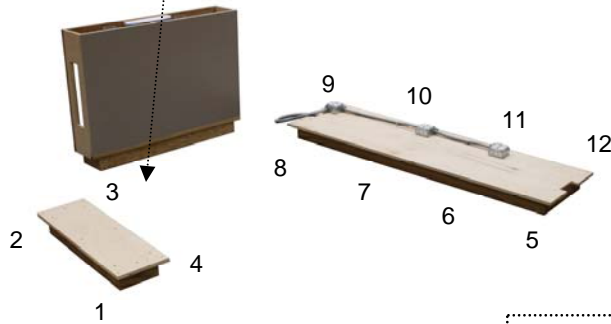

**Note :** Numbers are located on the top of corner posts as well as bases

## 2. Attach End Panels

Secure end panels to base on both sections with 7/8 x 1/4 x 20 hex head bolts



### 3. Attach Face Frames

Secure face frames to corner posts on end panels with #10 Truss head screws



Bolt corner posts on face frames to base with 7/8 x 1/4 x 20 hex head bolts

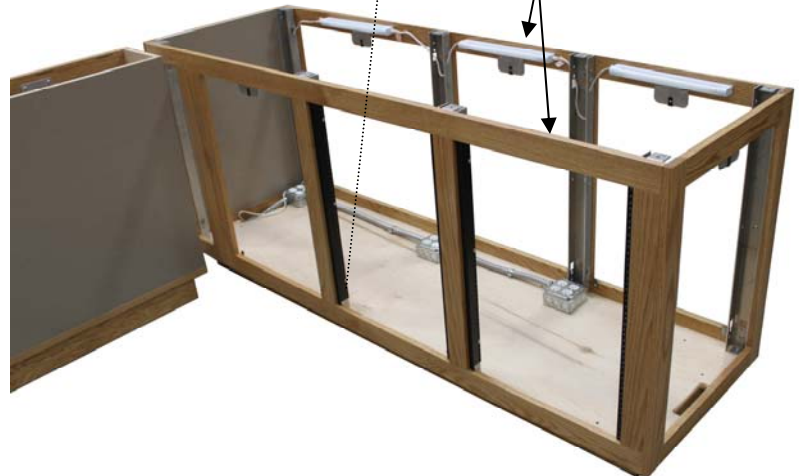
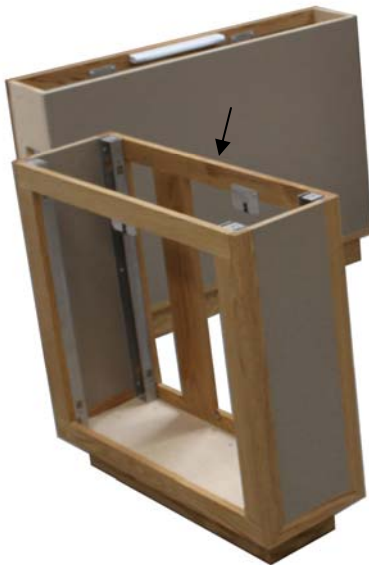

*Shown with optional  
A/C Lighting package*

#### 4. Secure Punch Block Cabinet

Position PBC between side cabinets

*Note : Punch block cabinet is unhandled. Access doors may be positioned to the front or the rear*

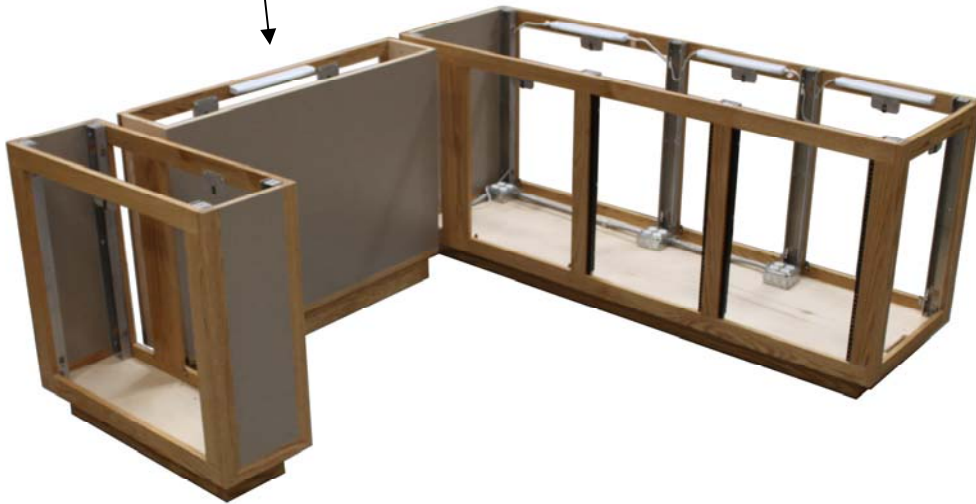

Attach punch block cabinet to right & left sides with 1/4 x 20 x 2 hex head bolts & washers

*Insure that the panels & punch block cabinet are all even with the top of the corner posts*

*Note : Good time to install wiring*

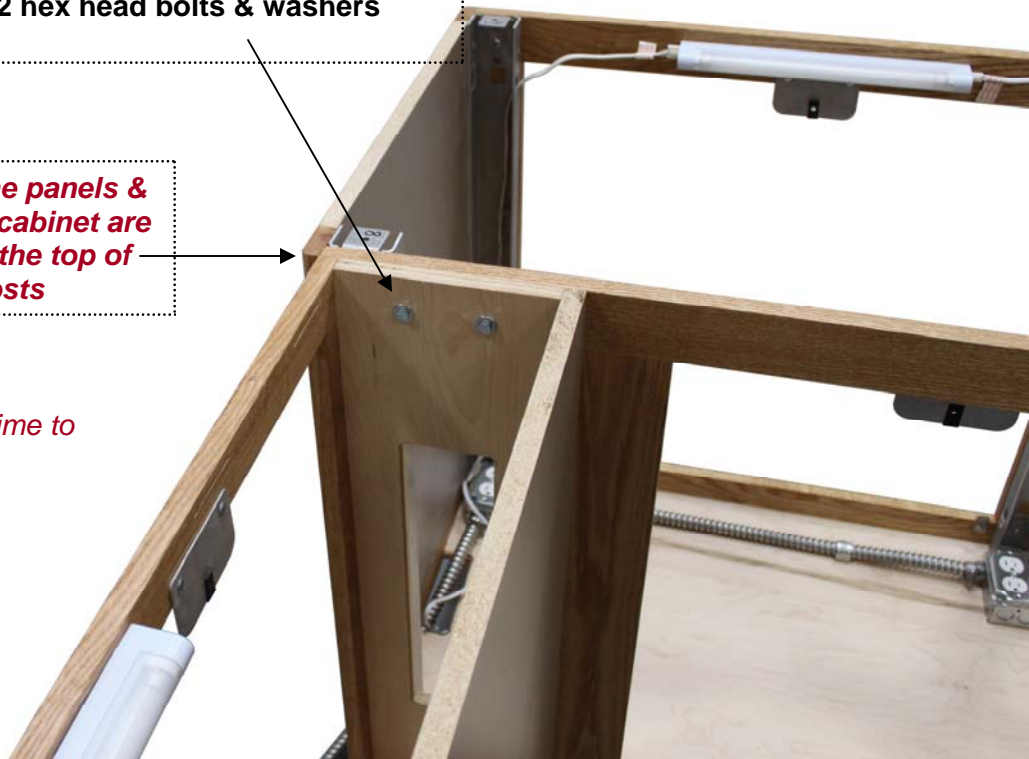

## 5. Attach Door Panels

Secure door panels with #10 3/4 truss head screws



## 6. Attach Legs & HP Assembly

Secure legs with 1" Phillips pan head screws in pre-marked area

Secure guest HP assembly with #10 3/4 Truss head screws in pre-drilled holes



## 7. Install Tops

Place interview top section as shown. Secure with #10 Truss head screws

*Do not tighten screws until tops are aligned*



*Note : The tops have a spline & groove to help with alignment*

Place center section. Bolt the 2 sections together with the draw bolts as shown.

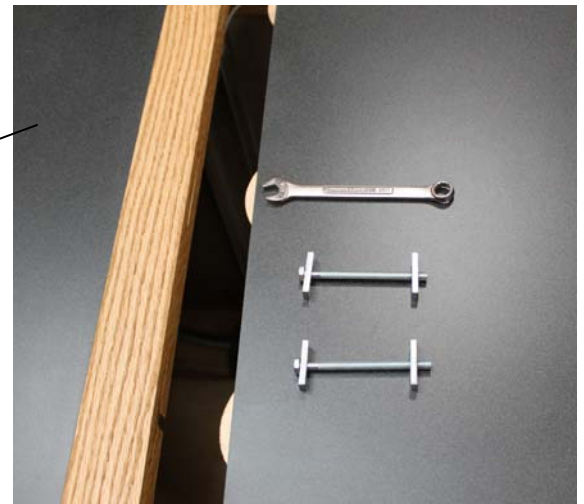

Lay up right section. Bolt the 2 sections together with the draw bolts shown



Attach tops to corner posts using #10 3/4 Truss head screws.

*Do not tighten screws until all screws are started and aligned.*

*Note : Remove door(s) if needed for easier access*

**Start with the outside rear corner**

